

MOUZA: CHURDI
P.H.No.: 10
TAH.: TIRODA
DIST.: BHANDARA

LOCATION PLAN
NOT TO SCALE

PROPOSED PLAN FOR LAYOUT
OF COMMERCIAL USE SCHOOL
BUILDING (ASIM SARAF CENTRAL
ACADEMY) AT GAT No. 347, 348 &
349, MOUZA-CHURDI, P.H.No.-14,
TAHSIL-TIRODA, DIST.-GONDIA. (MS)

SCHEDULE OF PLOTS
STATEMENT OF AREA

TOTAL AREA OF LAND OF GAT No. 347 (0.64 HR)	: 6,400.00 SQ.MT.
TOTAL AREA OF LAND OF GAT No. 348 (0.37 HR)	: 3,700.00 SQ.MT.
TOTAL AREA OF LAND OF GAT No. 349 (0.39 HR)	: 3,900.00 SQ.MT.
TOTAL AREA OF LAND UNDER SCHOOL	: 14,000.00 SQ.MT.

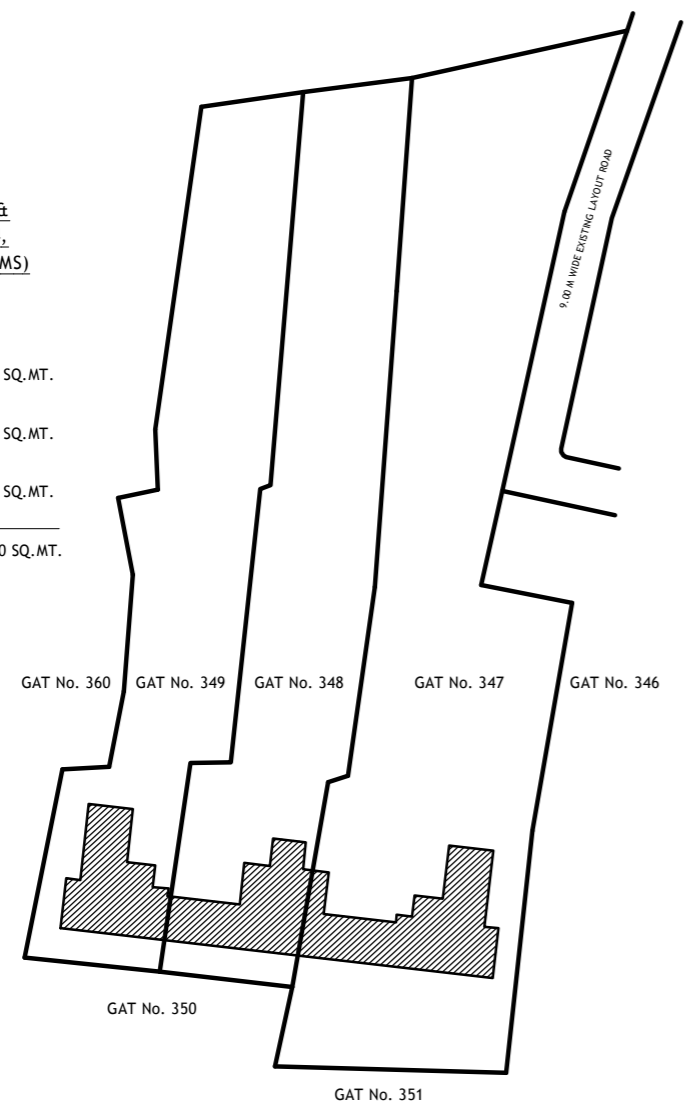

SITE PLAN
SCALE - 1:200

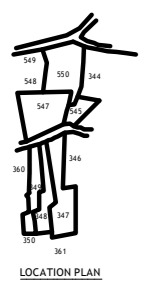

LOCATION PLAN